

Protective screen installation guide

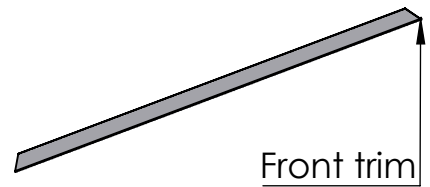

Front trim

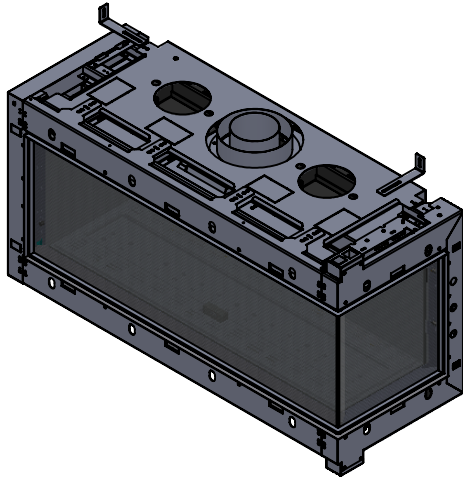

Side trim

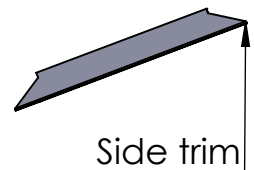

Side trim

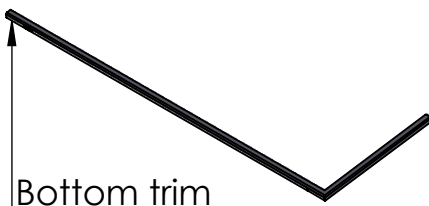

Bottom trim

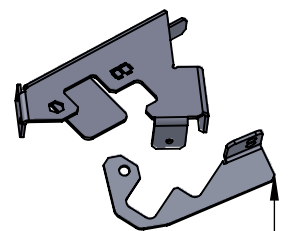

Glass corner brackets

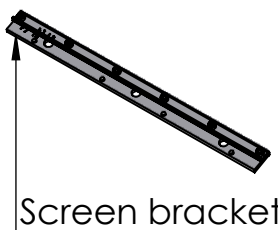

Screen bracket

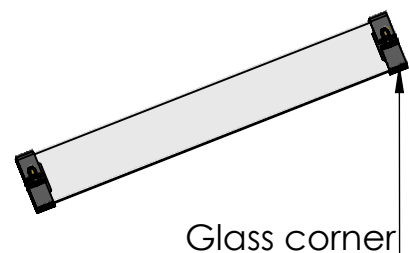

Glass corner

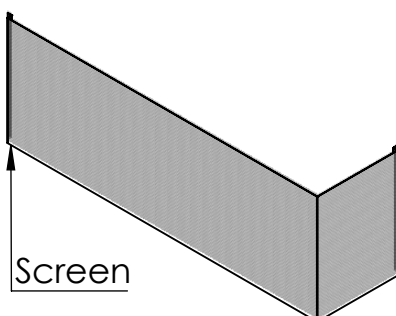

Screen

1. Remove the side trim by pulling out from the top as shown in figure (1).

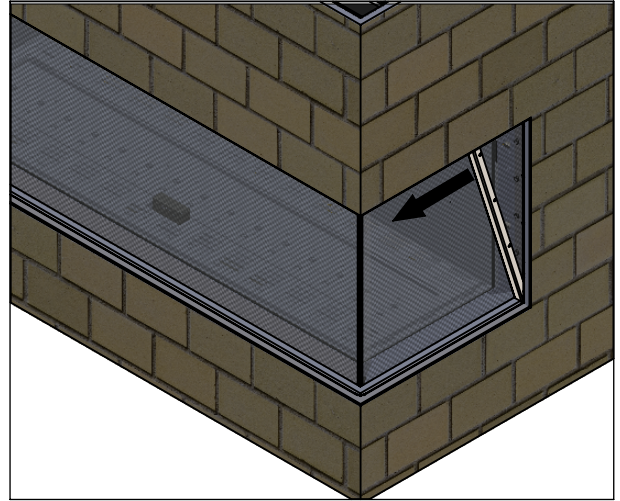

Figure (1)

2. Remove the bottom trim by pulling up from the end as shown in figure (2).

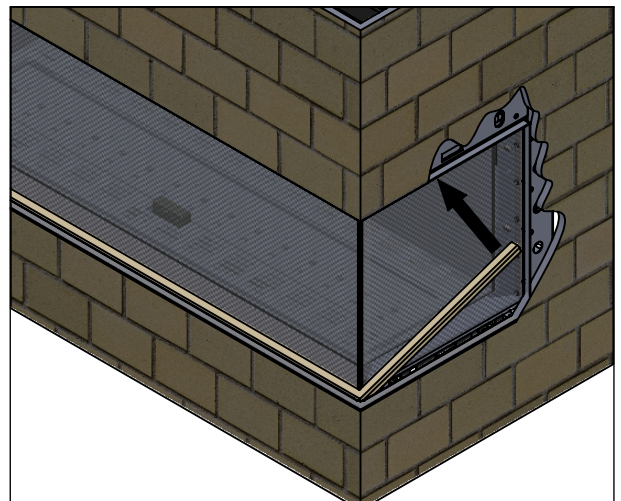

Figure (2)

3. Remove the 4-5 mm hex bolts with 5 mm allen wrench as shown in figure (3).

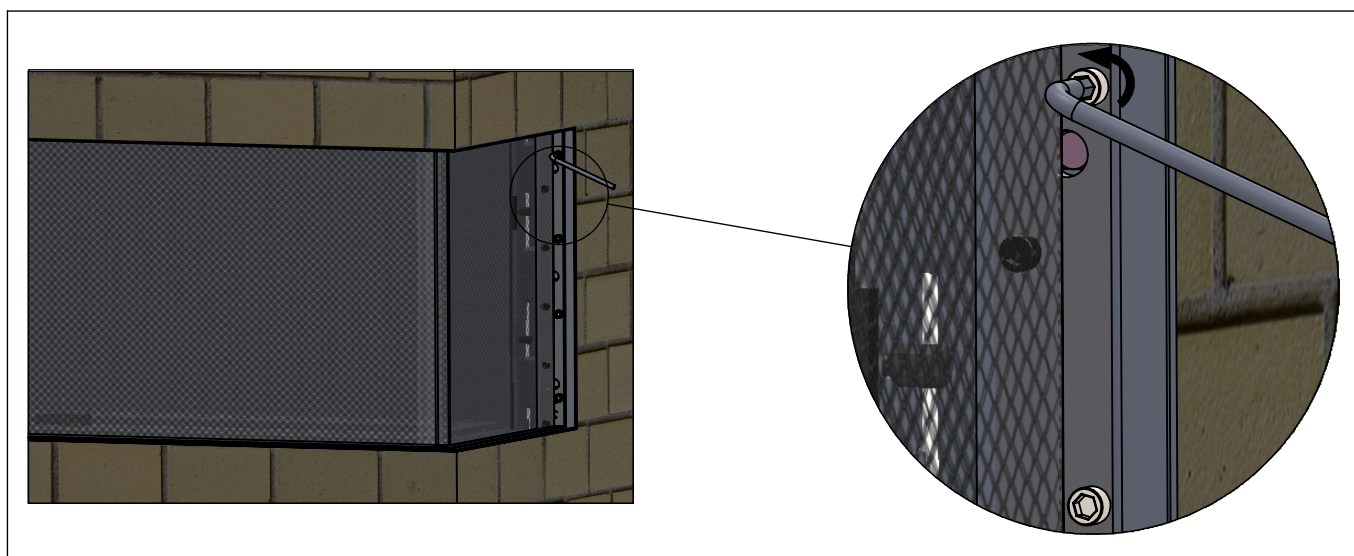

figure (3)

4. Remove the protective screen:

A. Twist the screen bracket 90 degree, as shown in figure (4).

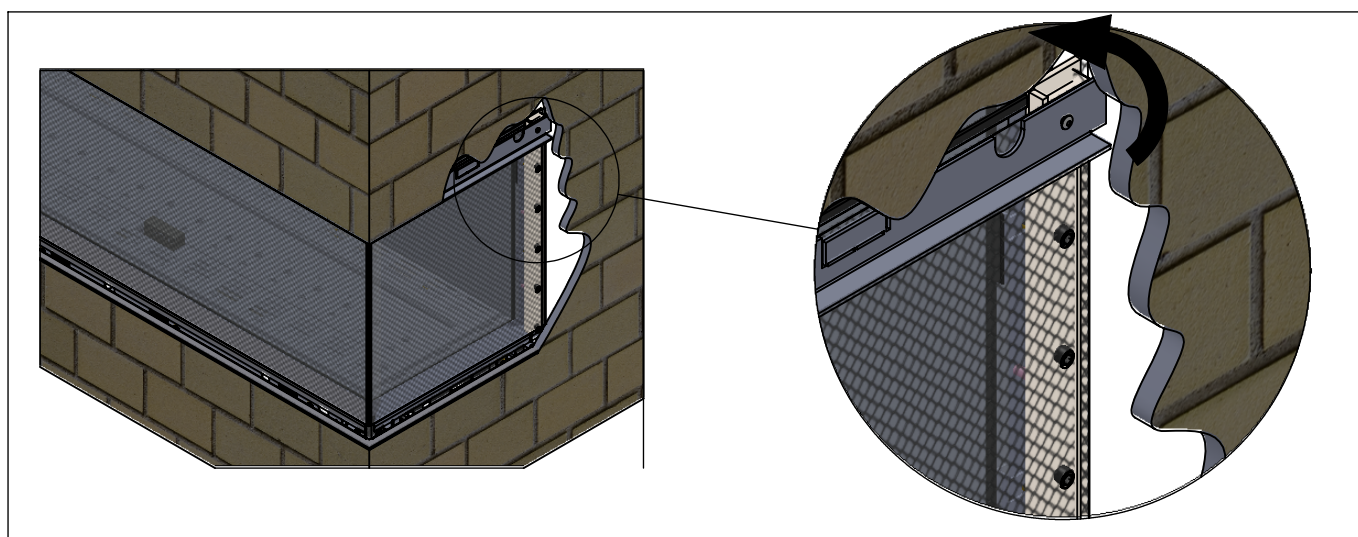

Figure (4)

B. Gently tilt the screen bracket from the top down and towards you, as shown in figure (5).

C. Carefully remove the screen.

D. Roll up and set aside.

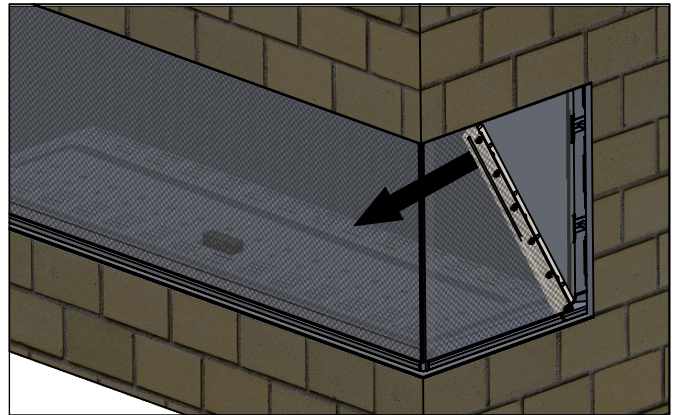

Figure (5)

5. Remove the trims in front of the glass:

A. Lift the trim up from the end.

B. Remove the trim, (see figure (6)).

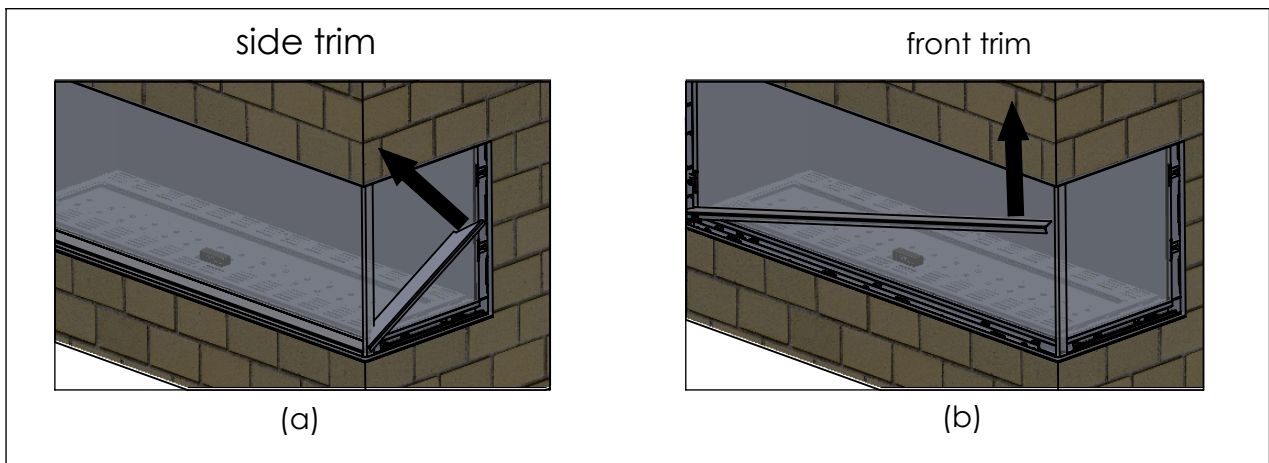

figure (6)

5. Remove the corner glass (only as needed).

- A. Remove the two screws from the bottom bracket, then remove it, (see figure (7)).

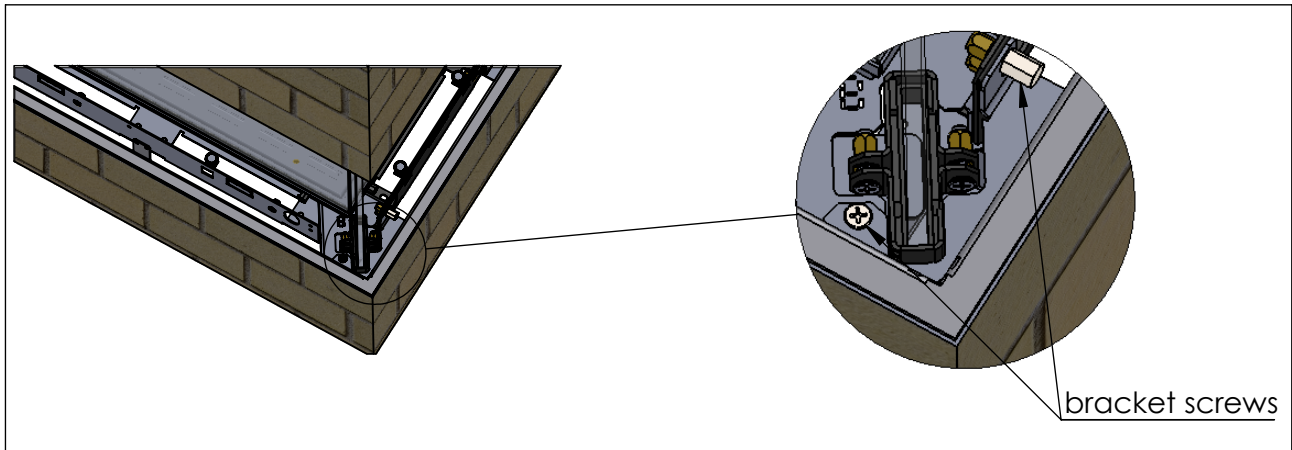

figure (7)

- B. While holding the glass corner remove the upper bracket.
- C. Rotate the glass corner as shown in figure (8).
- D. Lift up the glass corner as shown in figure (9.a).
- E. Tilt the glass corner by pulling from the bottom to the right as shown in figure (9.b), and remove it.

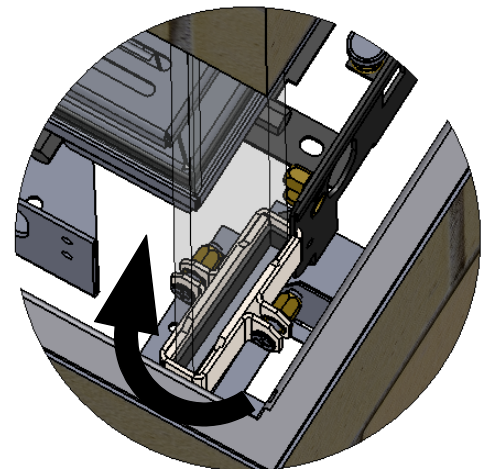

figure (8)

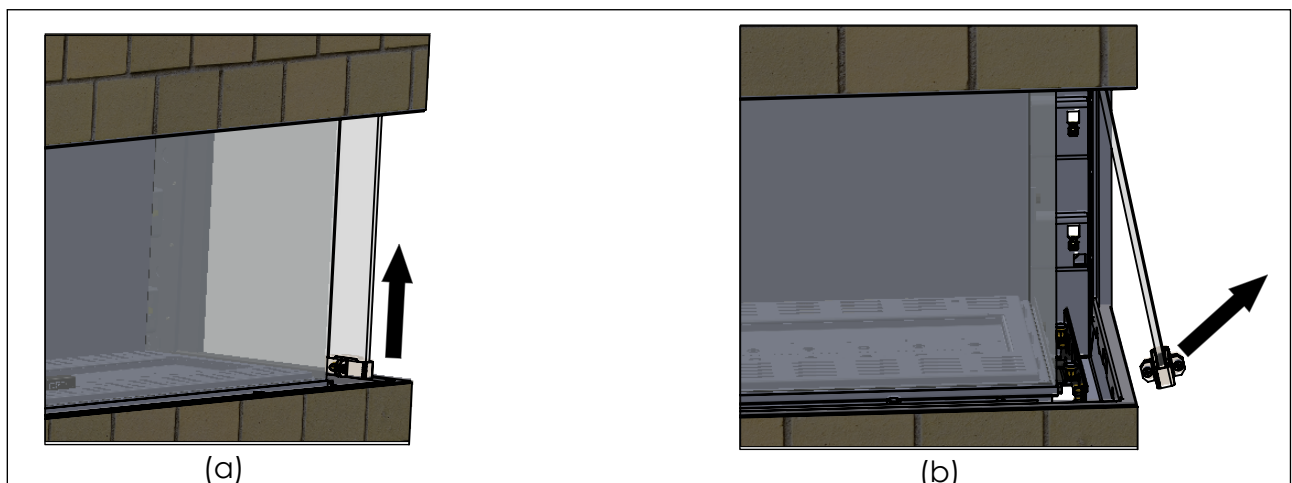

figure (9)